

PSIEC RAIKOT

LAYOUT PLAN FOR (11 D) MINI GROWTH CENTRE AT RAIKOT DISTT. LUDHIANA.

TOTAL AREA OF SCHEME
= 70.13 ACS

DETAIL OF PLOTS:-

S.NO.	CATEGORY	NO. OF PLOTS	AREA IN ACS.
01	3.00 ACS. PLOT	02	07.44
02	2.00 ACS. AND ABOVE PLOTS	03	06.82
03	1.00 ACS. PLOTS	04	04.00
04	2000 SQ. YDS AND ABOVE PLOTS	06	03.40
05	1000 SQ. YDS	41	09.38
06	500 SQ. YDS	67	07.20
07	250 SQ. YDS	28	01.48
TOTAL		151	39.72 ACS.

DETAIL OF AREAS:-

S. NO.	CATEGORY	AREA IN ACS.	% AGE
01	AREA UNDER PLOT INDUSTRIAL	39.72	56.64
02	AREA UNDER COMMERCIAL	03.59	05.11
03	AREA UNDER PB. BUILDINGS	01.42	02.02
04	AREA UNDER WEIGH BRIDGE	00.26	00.38
05	AREA UNDER PETROL PUMP	00.45	00.65
06	AREA UNDER ELECT. SUB STN.	00.93	01.33
07	AREA UNDER DISPOSAL	02.39	03.40
08	AREA UNDER WATER WORKS	01.11	01.59
09	AREA UNDER RESERVED	01.85	02.64
10	AREA UNDER OPEN SPACE	05.04	07.18
11	AREA UNDER ROADS	13.37	19.06
TOTAL SALEABLE		43.29 ACS.	61.72 %
TOTAL		70.13 ACS	100%

OFFICE OF THE
PUNJAB SMALL INDUSTRIES
& EXPORT CORPORATION
UDYOG BHAWAN,
SECTOR:-17, CHANDIGARH.

SCALE:- 200'-0" TO AN INCH
DRG. NO. PSIEC/G.M/PLG/LP-32/2021

DATED :- 23-01-1999
REV:-29-11-2019,
REV:-22-12-2020,
REV:-28-01-2021

(VINOD DHIMAN)
DRAWN / PLANNING BY :-
(ER. J.S BHATIA)
GENERAL MANAGER PLANNING

(ASHIMA AGGARWAL)
ASSISTANT TOWN PLANNER

CLICK LINK BELOW TO SEE LOCATION ON GOOGLE MAP.

<https://www.google.co.in/maps/search/RAIKOT+FOCAL+POINT+/@30.6439937,75.5778727,641m/data=!3m1!1e3?hl=en>

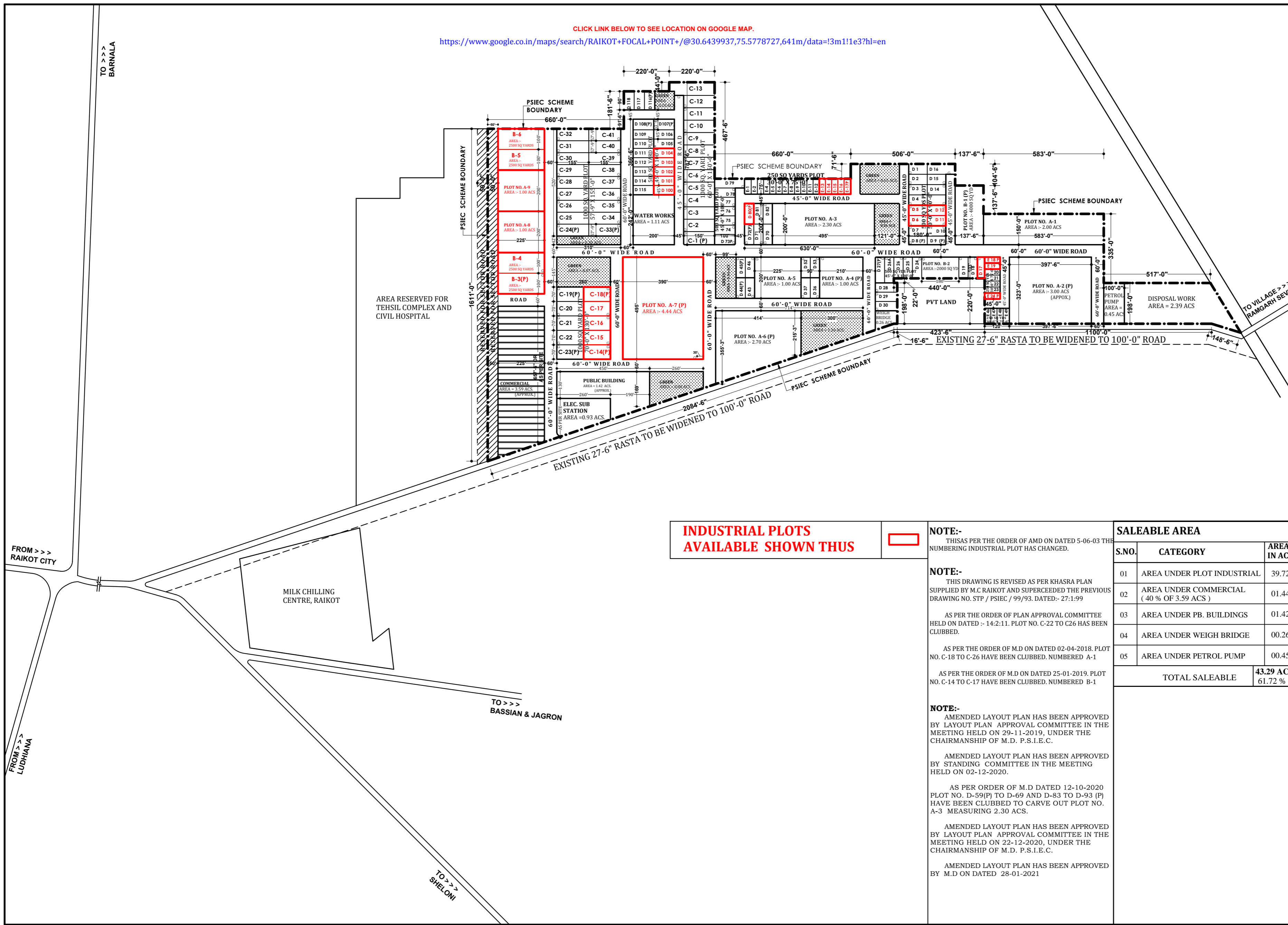

**INDUSTRIAL PLOTS
AVAILABLE SHOWN THUS**

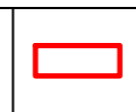

NOTE:-
THIS AS PER THE ORDER OF AMD ON DATED 5-06-03 THE NUMBERING INDUSTRIAL PLOT HAS CHANGED.

NOTE:-
THIS DRAWING IS REVISED AS PER KHASRA PLAN SUPPLIED BY M.C RAIKOT AND SUPERCEDED THE PREVIOUS DRAWING NO. STP / PSIEC / 99/93. DATED:- 27-1-99

AS PER THE ORDER OF PLAN APPROVAL COMMITTEE HELD ON DATED :- 14-2-11. PLOT NO. C-22 TO C26 HAS BEEN CLUBBED.

AS PER THE ORDER OF M.D ON DATED 02-04-2018. PLOT NO. C-18 TO C-26 HAVE BEEN CLUBBED. NUMBERED A-1

AS PER THE ORDER OF M.D ON DATED 25-01-2019. PLOT NO. C-14 TO C-17 HAVE BEEN CLUBBED. NUMBERED B-1

NOTE:-
AMENDED LAYOUT PLAN HAS BEEN APPROVED BY LAYOUT PLAN APPROVAL COMMITTEE IN THE MEETING HELD ON 29-11-2019, UNDER THE CHAIRMANSHIP OF M.D. P.S.I.E.C.

AMENDED LAYOUT PLAN HAS BEEN APPROVED BY STANDING COMMITTEE IN THE MEETING HELD ON 02-12-2020.

AS PER ORDER OF M.D DATED 12-10-2020 PLOT NO. D-59(P) TO D-69 AND D-83 TO D-93 (P) HAVE BEEN CLUBBED TO CARVE OUT PLOT NO. A-3 MEASURING 2.30 ACS.

AMENDED LAYOUT PLAN HAS BEEN APPROVED BY LAYOUT PLAN APPROVAL COMMITTEE IN THE MEETING HELD ON 22-12-2020, UNDER THE CHAIRMANSHIP OF M.D. P.S.I.E.C.

AMENDED LAYOUT PLAN HAS BEEN APPROVED BY M.D ON DATED 28-01-2021

SALEABLE AREA

S.NO.	CATEGORY	AREA IN ACS.
01	AREA UNDER PLOT INDUSTRIAL	39.72
02	AREA UNDER COMMERCIAL (40 % OF 3.59 ACS)	01.44
03	AREA UNDER PB. BUILDINGS	01.42
04	AREA UNDER WEIGH BRIDGE	00.26
05	AREA UNDER PETROL PUMP	00.45
TOTAL SALEABLE		43.29 ACS.
		61.72 %

TO >>> BARNALLA

FROM >>> RAIKOT CITY

FROM >>> LUDHIANA

TO >>> BASSIAN & JAGRON

TO >>> SHELONI

AREA RESERVED FOR TEHSIL COMPLEX AND CIVIL HOSPITAL

MILK CHILLING CENTRE, RAIKOT

EXISTING 27'-6" RASTA TO BE WIDENED TO 100'-0" ROAD

EXISTING 27'-6" RASTA TO BE WIDENED TO 100'-0" ROAD

TO VILLAGE >>> RAMGARH BEVIAN