

# PSIEC LUDHIANA

## LAYOUT PLAN FOR TAJPUR ROAD, ADJOINING CENTRAL JAIL, LUDHIANA

**TOTAL AREA OF THE SCHEME:-**  
= 15.00 ACS.

### DETAIL OF PLOTS:- (INCL.)

S.NO.	CATEGORY OF PLOT	NO. OF PLOTS	AREA IN ACS.
01	4300 SQ. YARDS PLOTS	04	03.56
02	3100 SQ. YARDS PLOTS	02	01.28
03	2500 SQ. YARDS PLOTS	01	00.65
04	1500 SQ. YARDS PLOTS	07	02.54
05	1000 SQ. YARDS PLOTS	04	00.83
<b>TOTAL</b>			<b>8.86 ACS.</b>

### DETAIL OF AREAS:-

S. NO.	CATEGORY	AREA IN ACS.	% AGE
01	AREA UNDER PLOTS	08.86	59.06
02	AREA UNDER COMMERCIAL	01.49	09.94
03	AREA UNDER TUBE WELL	00.17	01.14
04	AREA UNDER OPEN SPACE	00.66	04.40
05	AREA UNDER ROAD	01.20	08.00
06	AREA UNDER RESERVED AREA	02.62	17.46
<b>TOTAL</b>		<b>15.00 ACS.</b>	<b>100%</b>

### SALEABLE AREA

S.NO.	CATEGORY	AREA IN ACS.
01	AREA UNDER PLOT IND.	08.86
02	AREA UNDER COMMERCIAL (40% OF 1.49 AREA)	00.59
<b>TOTAL SALEABLE</b>		<b>9.45 ACS. 63.00 %</b>

OFFICE OF THE  
PUNJAB SMALL INDUSTRIES  
& EXPORT CORPORATION  
UDYOG BHAWAN,  
SECTOR-17, CHANDIGARH.

SCALE :- 40'-0" TO AN INCH  
DRG. NO. PSIEC/G.M/PLG/L.P-28/2020  
DATED :- 03-08-2015  
REV:- 18-08-2020,

(VINOD DHIMAN)  
DRAWN/ PLANNING BY :-

(ASHIMA AGGARWAL)  
ASSISTANT TOWN PLANNER

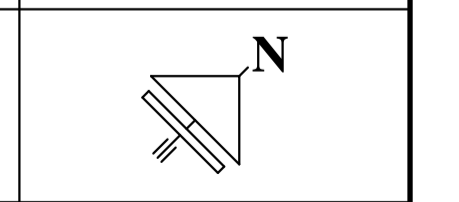

(ER. J.S BHATIA)  
GENERAL MANAGER PLANNING

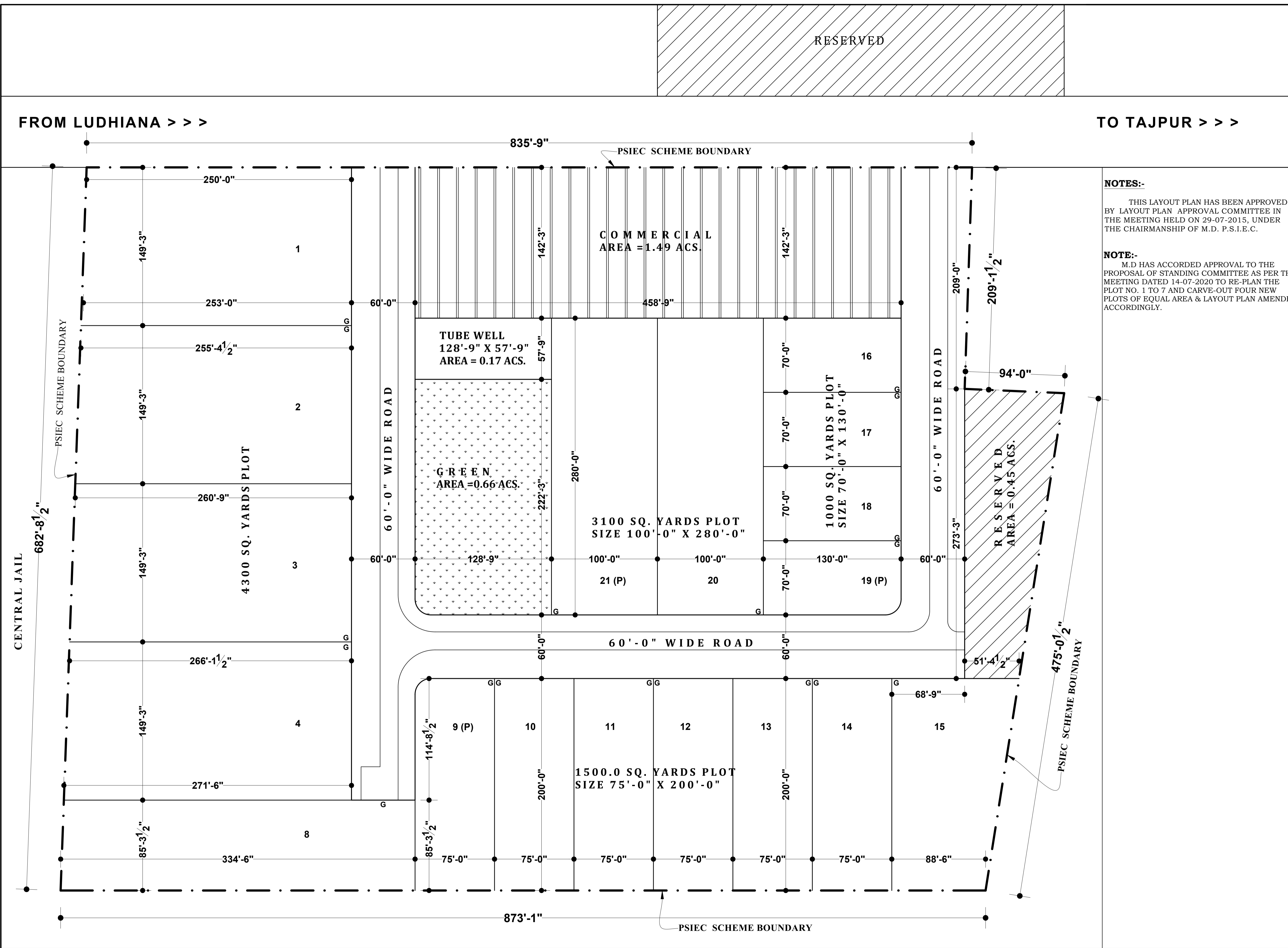

**NOTES:-**  
THIS LAYOUT PLAN HAS BEEN APPROVED BY LAYOUT PLAN APPROVAL COMMITTEE IN THE MEETING HELD ON 29-07-2015, UNDER THE CHAIRMANSHIP OF M.D. P.S.I.E.C.

**NOTE:-**  
M.D HAS ACCORDED APPROVAL TO THE PROPOSAL OF STANDING COMMITTEE AS PER THE MEETING DATED 14-07-2020 TO RE-PLAN THE PLOT NO. 1 TO 7 AND CARVE-OUT FOUR NEW PLOTS OF EQUAL AREA & LAYOUT PLAN AMENDED ACCORDINGLY.

FROM LUDHIANA >>> TO TAJPUR >>>

RESERVED

COMMERCIAL AREA = 1.49 ACS.

TUBE WELL 128'-9" X 57'-9" AREA = 0.17 ACS.

GREEN AREA = 0.66 ACS.

3100 SQ. YARDS PLOT SIZE 100'-0" X 280'-0"

1000 SQ. YARDS PLOT SIZE 70'-0" X 130'-0"

RESERVED AREA = 0.45 ACS.

1500.0 SQ. YARDS PLOT SIZE 75'-0" X 200'-0"

PSIEC SCHEME BOUNDARY