

LAYOUT PLAN FOR INDUSTRIAL FOCAL POINT AT GOINDWAL SAHIB, PHASE- I

CLICK LINK BELOW TO SEE LOCATION ON GOOGLE MAP. https://www.google.co.in/maps/place/Goindwal+Sahib,+Punjab+143422/@31.3558103,75.1358541,1311m/data=!3m1!1e3!1m3!1m1!1s0x391a2e3a13003cd3:0xc0017a6670158840:8m2!3d31.3638402!4d75.1370254!hl=en

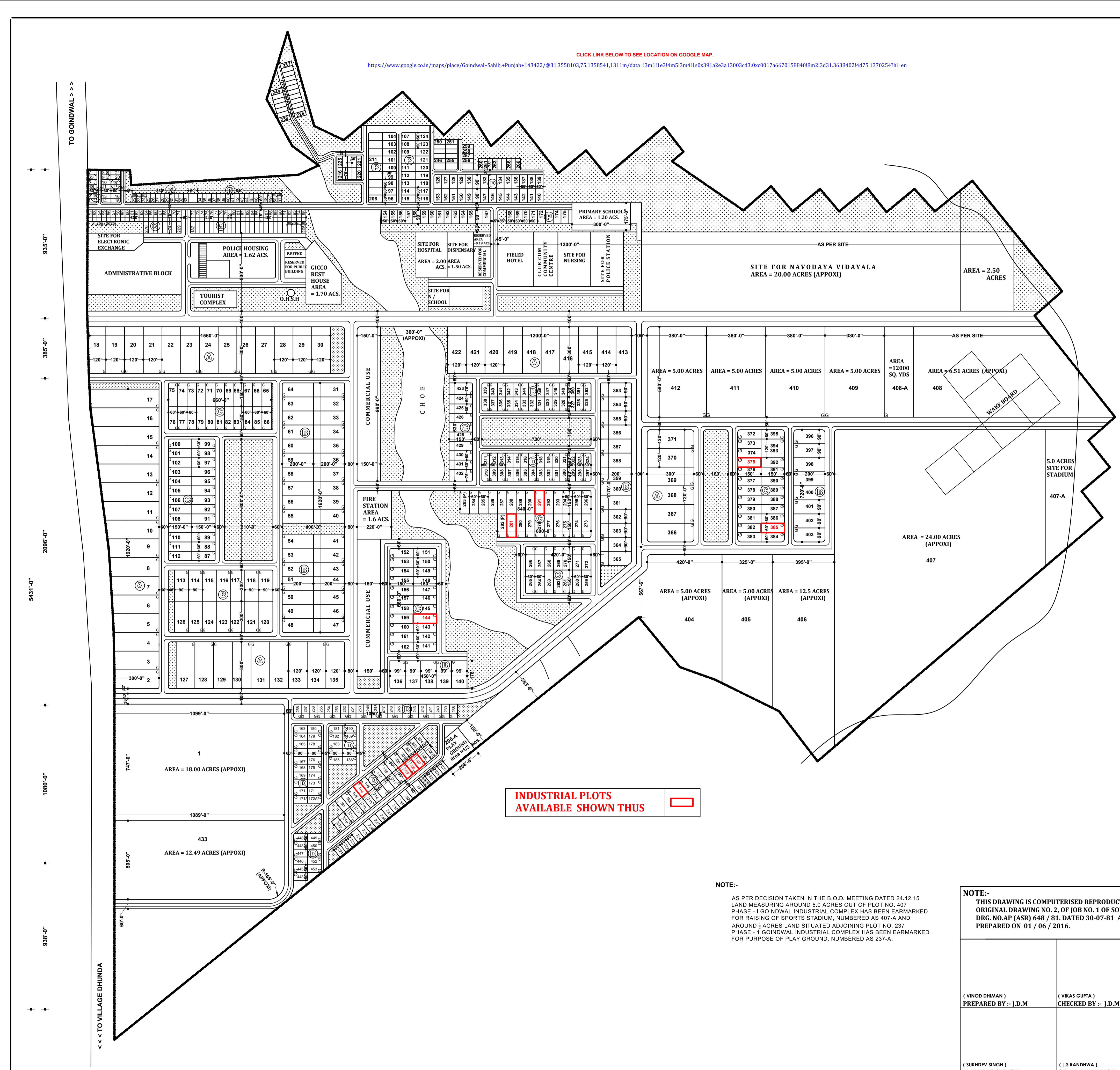

DETAIL OF INDUSTRIAL PLOTS:-

Table with 4 columns: S. NO., CATEGORY OF PLOT, SIZE, NO. OF PLOTS. Lists plots A through E with their respective categories and sizes.

DETAIL OF RESIDENTIAL PLOTS

Table with 4 columns: S. NO., CATEGORY OF PLOT, SIZE, NO. OF PLOTS. Lists plots P through R with their respective categories and sizes.

NOTE:-

- 1) AFTER THE JOINT INSPECTION BY THE C.E. (P.S.I.E.C.) & C.E. (GICCO) THE C/C DISTANCES OF ROADS ALONG WITH ROAD FROM GOINDWAL TO DHUNDA HAVE BEEN MARKED ON THE PLAN.
2) LAYOUT HAS BEEN REVISED AFTER THE DISCUSSION WITH C.E. (GICCO) ON 16.11.81.
3) LAYOUT HAS BEEN REVISED FOR LOCATION OF ROAD ON 27.01.82.
4) SCHEME BOUNDARY HAS BEEN AMENDED AS PER SURVEY SUBMITTED BY S.D.E. - I (P.H.) GICCO, DATED 04.02.82.
5) LAYOUT HAS BEEN AMENDED ON DATED 28.07.1982.
6) THE LAYOUT HAS BEEN AMENDED ON DATED 12.10.82. FOR BOUNDARY LINE AND PLOT OF SPINFIELD. AMENDED OF BOUNDARY LINE IS DONE ACCORDING TO THE POSITION MARKED AND SENT BY E.E. CONST. II VIDE LETTER DATED 07.10.82.
7) THE POSITIONS OF GURUWARA BAJJI SAHIB DERA (MAHANT) AND MARK BOARD HAS BEEN MARKED AS PER DRAWING RECEIVED FROM E.E. CONST. I VIDE LETTER NO. BR 31/656 DATED 21.11.83.
8) TWO MORE PLOTS NO. 171-A AND 172-A HAS BEEN CARVED OUT AS PER INFORMATION GIVEN BY THE E.E./GICCO, GOINDWAL VIDE NO. GICCO/BR/31/88/01 DATED 04.01.88.
9) THE SIZE OF PLOT NO. 136 TO 140 HAVE BEEN AMENDED AS 99'-0" X 176'-0" AS AGAINST 90'-0" X 200'-0" HAS ALREADY PLANNED AS ORDER OF WORTHY C.E. VIDE LETTER NO. GICCO/CE/DBH/136 DATED 19.09.88.
10) 12'-0" WIDE ACCESS TO THE LAND OF MAHANT HAS BEEN SHIFTED FROM ITS EXISTING POSITION AS PER LETTER NO. GICCO / CED / 4 / VOL. III / 90 / 2484-85. DATED 29.05.90.
11) AS PER THE ORDER OF WORTHY M.D. ON DATED. 15.04.11 12000 SQ. YARDS AREA HAS BEEN KEPT RESERVED FOR MIS MILK FOOD PVT. LTD. NUMBERED AS 408-A OUT OF PLOT NO. 408.
12) AS PER LETTER OF CHIEF TOWN PLANNER PUNJAB NO. 2268 C.T.P (PB) SG-34, DATED 26-07-91. LAND ADJOINING COMMERCIAL SITE PLOCKET A EARLIER MARKED FOR COMMUNITY CENTRE HAS BEEN CONVERTED INTO SITE FOR FIRE STATION

SOURCE :-DRG. NO.AP (ASR) 648 / 81 DATED 30-07-81

OFFICE OF THE CHIEF ENGINEER, PUNJAB SMALL SCALE INDUSTRIES & EXPORT CORPORATION UDYOG BHAWAN, SECTOR-17, CHANDIGARH.

Scale: 220'-0" TO AN INCH. Traced by: Sd/-. Checked by: Sd/-. Drawn by: Sd/-. (VIJAY MALHOTRA). Job No. 1, 2. Drg. No. Sd/-. Sd/-. (SUKHDEV SINGH) PLANNING OFFICER :- (J.S. RANDHWA) GENERAL MANAGER PLANNING ASSTT. ENGINEER DESIGN:- CHIEF ENGINEER

NOTE:- AS PER DECISION TAKEN IN THE B.O.D. MEETING DATED 24.12.15 LAND MEASURING AROUND 5.0 ACRES OUT OF PLOT NO. 407 PHASE - I GOINDWAL INDUSTRIAL COMPLEX HAS BEEN EARMARKED FOR RAISING OF SPORTS STADIUM, NUMBERED AS 407-A AND AROUND 3 ACRES LAND SITUATED ADJOINING PLOT NO. 237 PHASE - I GOINDWAL INDUSTRIAL COMPLEX HAS BEEN EARMARKED FOR PURPOSE OF PLAY GROUND, NUMBERED AS 237-A.

NOTE:- THIS DRAWING IS COMPUTERISED REPRODUCTION OF ORIGINAL DRAWING NO. 2, OF JOB NO. 1 OF SOURCE :- DRG. NO.AP (ASR) 648 / 81. DATED 30-07-81 AND PREPARED ON 01 / 06 / 2016.

INDUSTRIAL PLOTS AVAILABLE SHOWN THUS [Red box symbol]

TO GOINDWAL >>> TO VILLAGE DHUNDA <<<