

DETAIL OF RESIDENTIAL PLOTS :-

TOTAL AREA OF RESIDENTIAL POKET:- = 9.96 ACS.

S.NO.	CATEGORY	NO. OF PLOTS	AREA IN ACS.
01	10 MARLA PLOTS	44	2.27
02	16 MARLA PLOTS	31	2.59
03			
TOTAL		75	4.86 ACS.

P S I E C PATIALA

LAYOUT PLAN FOR INDUSTRIAL FOCAL POINT AT PATIALA

SALEABLE AREA

S.NO.	CATEGORY	AREA IN ACS.
01	AREA UNDER PLOT IND.+RESI	120.40
02	AREA UNDER COMMERCIAL (40 % OF 1.54 AREA)	0.61
03	AREA UNDER ELECT. SUB. STN.	1.83
04	AREA UNDER PUBLIC BUILDINGS (75 % OF 0.80 AREA)	0.60
TOTAL SALEABLE		123.44 ACS. 65.88 %

TOTAL AREA OF THE SCHEME:- = 187.37 ACS.

DETAIL OF PLOTS:-

Sr. NO.	CATEGORY OF PLOT	SIZE OF PLOTS	NO. OF PLOTS	AREA IN ACS.
01	1.0 ACS. AND ABOVE PLOTS	150'-0" X 300'-0"	10	11.35
02	1/2 ACS. AND ABOVE PLOTS	90'-0" X 250'-0"	34	19.69
03	1/4 ACS. PLOTS	60'-0" X 150'-0"	231	47.74
04	500.0 SQ. YARDS PLOTS	45'-0" X 100'-0"	342	34.30
05	250.0 SQ. YARDS PLOTS	30'-0" X 75'-0"	47	02.46
TOTAL			664	115.54 ACS.

NOTE:-

- 1) SCHEME AREA WAS INCREASED FROM 186.80 ACRES TO 187.37 ACRES IN VIEW OF CORRIGENDUM ISSUED VIDE LAC / ASSTT/82 / PTA / 4091.D, DATED 28.07.1992.
- 2) LAYOUT PLAN HAS BEEN AMENDED AS PER PROCEEDING OF MEETING OF STANDING COMMITTEE DATED 12.01.2006 RE-PLANNED OF PLOT NO. D-152 TO D-158 AND C-111, B-34.
- 3) AS PER ORDER OF M.D ON DATED. 14-9-06 ONE 3916.66 SQ. YARDS PLOT HAS BEEN CARVED OUT AND NUMBERED AS B-28A OUT OF PLOT NO A-10.
- 4) AS PER ORDER OF MANAGING DIRECTOR DATED 04.04.2007 PLOT NO. C-219 HAS BEEN SHIFTED DUE TO (HIGH TENSION LINE) ADJOINING PLOT NO. C-218 AND LAND UNDER PLOT NO. C-219 CONVERTED INTO OPEN SPACE.
- 5) AS PER ORDER OF STANDING ORDER DATED 17.12.2010 LOCATION OF PLOT NO. R-29 TO R-44 AND R-60 TO R-75 HAS BEEN CHANGED.
- 6) AS PER ORDER OF M.D PSIEC DATED 14.11.2011 PLOT NO. B-28A HAS BEEN KEPT RESERVED FOR PHULKARI MRGA PROJECT.
- 7) AS PER THE ORDER OF BOARD OF DIRECTORS DATED 24.12.2015 ROAD ADJOINING PLOT NO. B-24 DE-RESERVED AND CARVED OUT 1642 SQ YARDS INDUSTRIAL PLOTS NUMBERED AS B-24A
- 8) AS PER DECISION TAKEN IN THE LAYOUT PLAN APPROVAL COMMITTEE DATED 05-10-2016. 1.54 ACS. COMMERCIAL POKET HAS BEEN PLANNED ON THE ENTRY POINT OF INDUSTRIAL FOCAL POINT & COMMERCIAL POKET ALREADY PLANNED HAS BEEN CONVERTED INTO GREEN BELT.

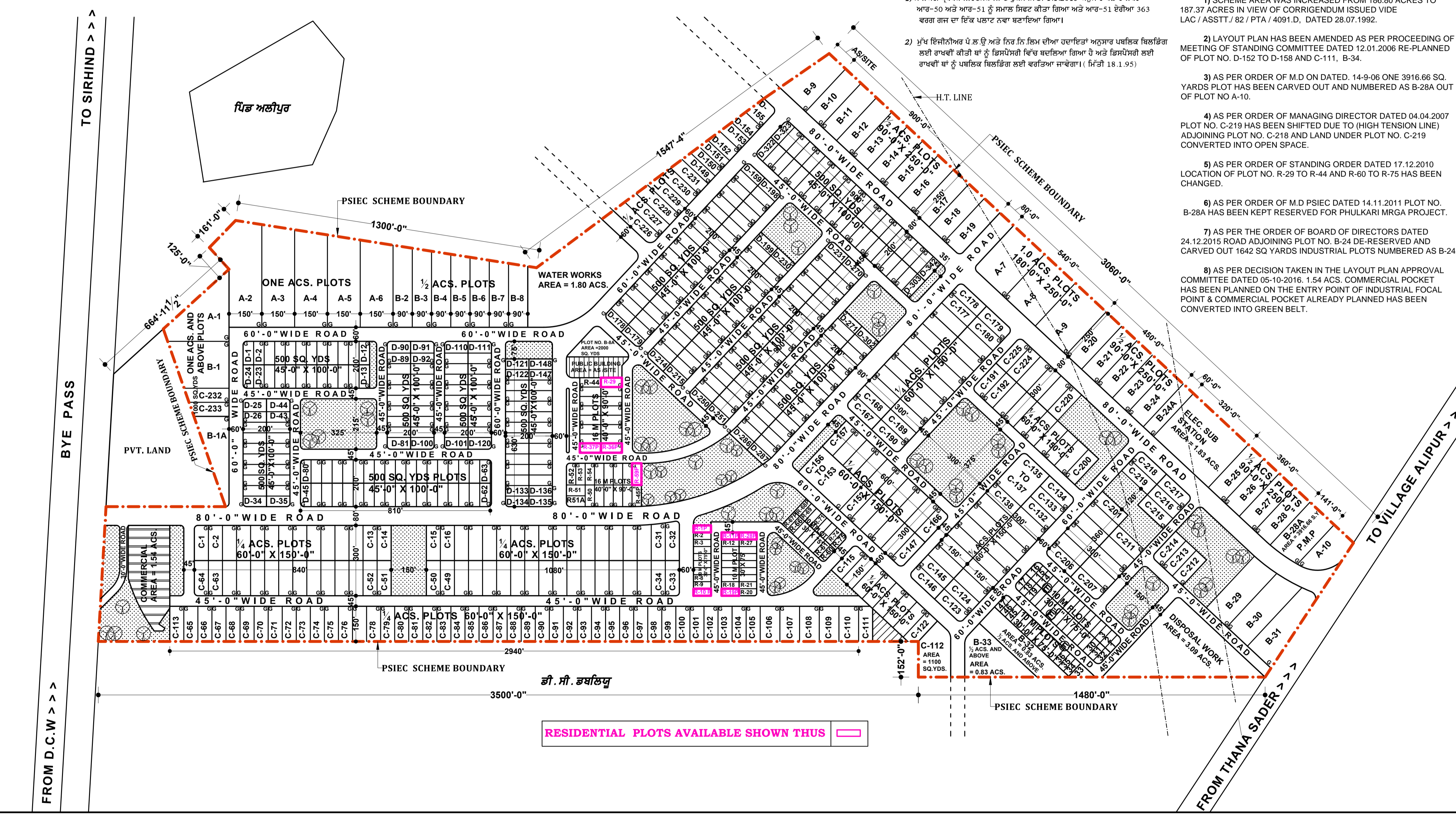

DETAIL OF AREAS:-

S. NO.	CATEGORY	AREA IN ACS.	% AGE
01	AREA UNDER PLOT INDUSTRIAL	115.54	61.66
02	AREA UNDER COMMERCIAL	1.54	0.82
03	AREA UNDER PUBLIC BUILDINGS	0.80	0.42
04	AREA UNDER ELECT. SUB. STN.	1.83	0.97
05	AREA UNDER WATER WORKS	1.80	0.96
06	AREA UNDER ROAD/OPEN SPACE	52.81	28.18
07	AREA UNDER DISPOSAL WORKS	3.09	1.64
08	AREA UNDER RESIDENTI. POKET	9.96	5.31
TOTAL		187.37 ACS.	100%

**OFFICE OF
THE CHIEF ENGINEER,
PUNJAB SMALL
INDUSTRIES & EXPORT
CORPORATION UDYOG
BHAWAN, SECTOR:-17,
CHANDIGARH.**

NOTE:-
THIS DRAWING IS COMPUTERIZED REPRODUCTION OF ORIGINAL DRG. NO. P.S.I.E.C./E/W/D.T.P/01/11, DATED. 24.07.91 AND PREPARED ON 31/01/2017.

SCALE:- 220'-0" TO AN INCH	DRG. NO.:- P.S.I.E.C./E/W/D.T.P/01/11
DRAWN BY:- (SWARAN SINGH) Sd/-	DATED:- 24-07-91
(Y.P. SHARMA) Sd/-	PLANNING OFFICER:- (SATESH RANA) Sd/-
(VINOD DHIMAN) PREPARED BY:- J.D.M	(VIKAS GUPTA) CHECKED BY:- J.D.M
(JASWANT SINGH) ASSTT. TOWN PLANNER:- Sd/-	(S.D.SADHU) DIVISIONAL TOWN PLANNER/CHIEF ENGINEER Sd/-
(SUKHDEV SINGH) ASSTT. TOWN PLANNER:- Sd/-	(J.S.RANDHWA) GENERAL MANAGER PLANNING Sd/-